

Drawing name: K:\PHX_Aviation\115065008 Det. 4L\CADD\115065008PL.dwg G-PL-01 Mar 04, 2011 8:13am by: danny.harris

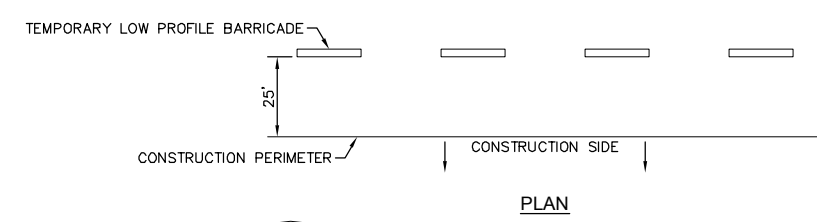

1 LOW PROFILE BARRICADE
G-PL-01 N.T.S.

- NOTES**
1. CONTRACTOR SHALL BE RESPONSIBLE FOR MAINTAINING PROPER POSITIONING OF ALL BARRICADES.
 2. LOW PROFILE BARRICADES SHALL BE PLACED PARALLEL TO THE CONSTRUCTION PERIMETER.

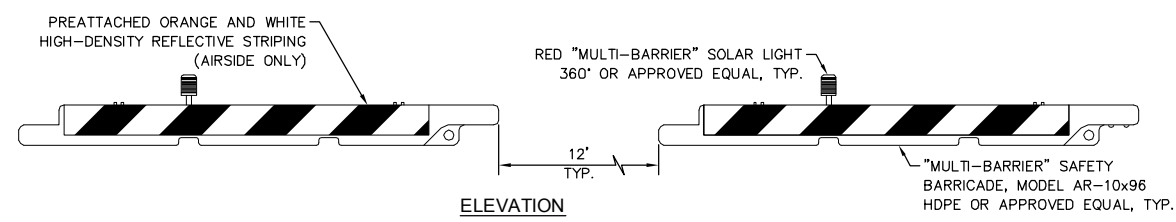
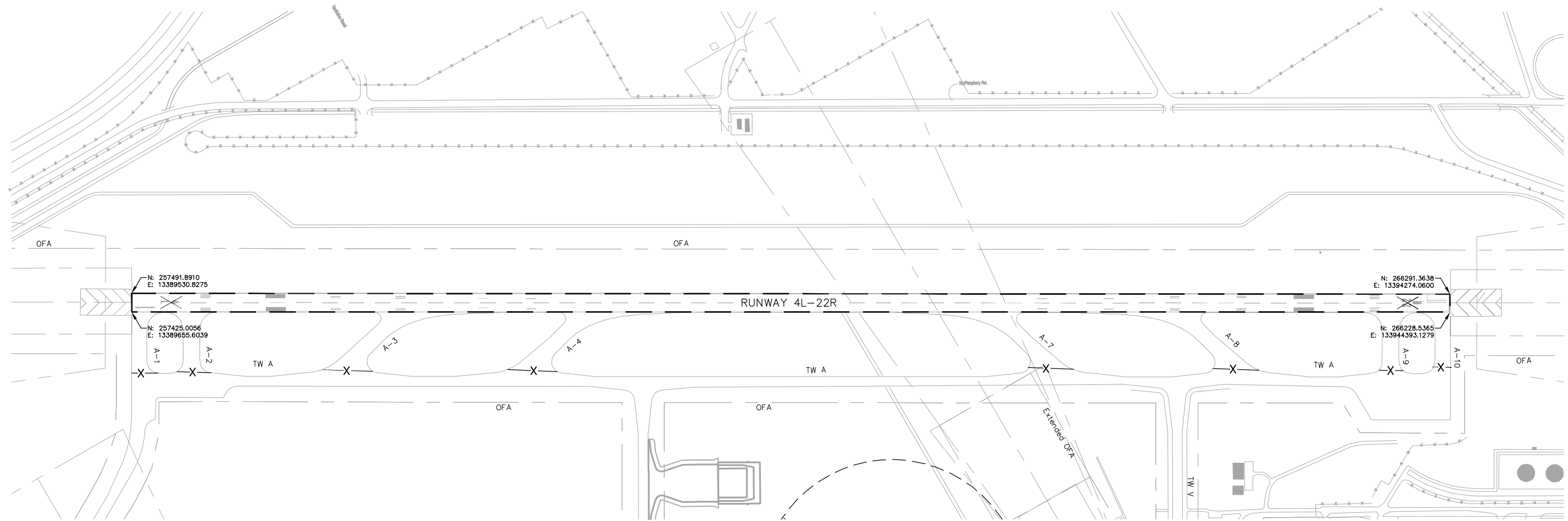
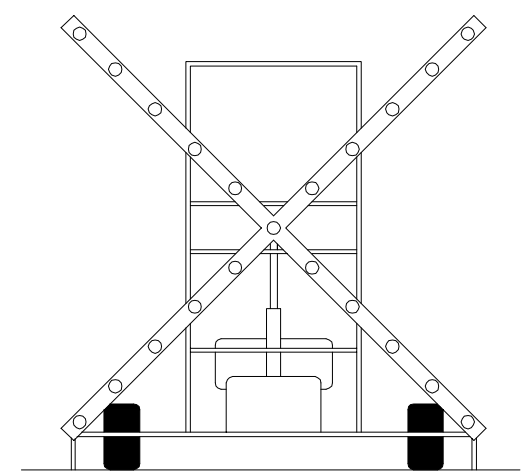

2 PORTABLE LIGHTED RUNWAY CLOSURE MARKER
G-PL-01 N.T.S.

- LEGEND**
- APPROXIMATE PROJECT LIMITS
 - X- LOW PROFILE BARRICADE
 - X PORTABLE LIGHTED RUNWAY CLOSURE MARKER

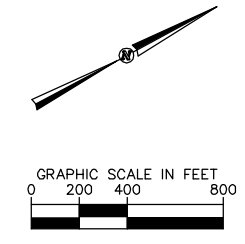

THIS RECORD CONTAINS SENSITIVE SECURITY INFORMATION THAT IS CONTROLLED IN 49 CFR PART 1520. NO PART OF THIS RECORD MAY BE DISCLOSED TO PERSONS WITHOUT A "NEED TO KNOW", AS DIRECTED IN 49 CFR PART 1520, EXCEPT WITH THE WRITTEN PERMISSION OF THE ADMINISTRATOR, THE TRANSPORTATION SECURITY ADMINISTRATION OR THE SECRETARY OF TRANSPORTATION. UNAUTHORIZED RELEASE MAY RESULT IN CIVIL PENALTY OR OTHER ACTION. FOR US GOVERNMENT AGENCIES, PUBLIC DISCLOSURE IS GOVERNED BY 5 U.S.C. 552 AND 49 CFR PART 1520.



PRELIMINARY DESIGN

REV.	DATE	APP'D	DESCRIPTION

DRAWING FILE:	115065008PL
DRAWN BY:	DBH
CHECKED BY:	CLW
APPROVED BY:	MAN

DETROIT METROPOLITAN WAYNE COUNTY AIRPORT
PAVEMENT JOINT REHABILITATION OF RUNWAY 4L-22R

INDEX OF DRAWINGS

WCAA Control No. S09-015A
Job No. 115065008
Date: 3/08/2011
SHEET
G-PL-01
Sheet Number 3